

DUPLEX GAUGE

NPR340

- Suitable For Use With All Foam Concentrates
- Operates Automatically Utilizing Foam Concentrate And Water Line Pressure
- Determine At A Glance If The Foam System Is Balanced And Operating Properly
- Used To Troubleshoot Problems Which Cause Improper Proportioning



Description

The Duplex Gauge is suitable for use with all foam concentrates. It operates automatically utilizing foam concentrate and water line pressure.

Specifications

Accuracy:

Within 1% of Scale Range

Bourdon Tube:

Phosphor Bronze with Forged Brass Sockets

Movement:

Bronze

Dial:

4-1/2" Dia. (114mm) White with Black Graduations and Numerals.

Graduations:

Figure Intervals - 50 psi; 345 kPa.
Small Graduations - 5 psi; 34 kPa.

Range:

0 to 400 psi; 0 to 2800 kPa.

Case:

Stainless Steel (GR 304). Surface Mount, 1/4" (6mm) NPT Connection.

Pointers:

Red Pointer is actuated by the Concentrate System and is connected to the "RH" connection.

The Black Pointer is actuated by the Water System and is connected to the "BH" Connection.

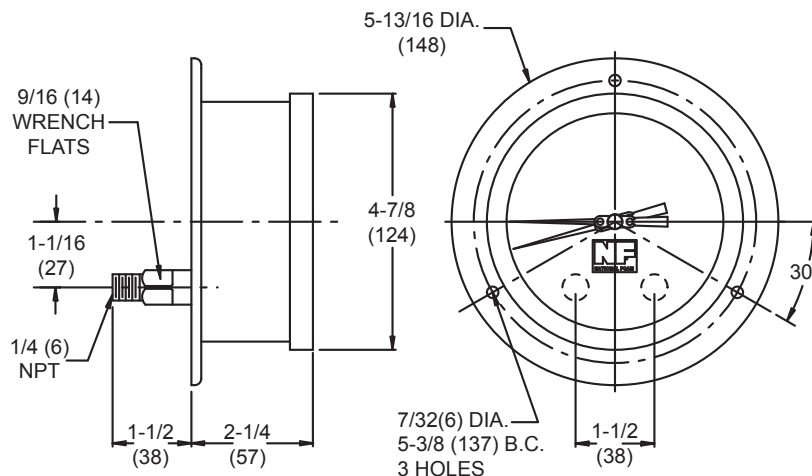

ORDERING INFORMATION

PART NUMBER

1234-1605-7

DESCRIPTION

Duplex Gauge, 0-400 psi, 1/4 Back Mount, 4-1/2 Brass with S/S Case, English & Metric Scales