

KF40 DIRECTIONAL ASPIRATED FOAM WATER NOZZLE

NDD410

- Capable Of Being Mounted In Any Position Or Direction
- Lightweight High-Grade Stainless Steel Construction
- BSP Or NPT Inlet
- Pinpoint Foam Application
- Loading Racks, Process Pumps, Process Piping
- Seawater Compatible
- AR-AFFF/AFFF and Protein Compatible



Description

The KF40 directional foam/water nozzle is constructed of stainless steel, and operates at a 3.1 K-factor. The nozzle shall be installed in fixed installations aimed in any direction. The nozzle is aspirated and suitable for use with AR-AFFF/AFFF and Protein foam solutions.

Features

- Capable of being mounted in any position
- Lightweight, investment cast welded, high-grade stainless steel construction
- BSP or NPT inlet
- Special order inlets available upon request

Applications

Ideal for loading racks, containment areas, rail car loading areas, heliports, truck loading racks, and process areas.

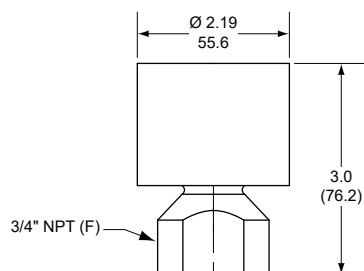

Technical Data

Description:

Foam/Water Nozzle

Manufacturer:

National Foam

Model:

Directional

K-factor:

3.1

Connection:

3/4" FNPT (w/o adapter 3/4" BSP)

Operating Range:

Minimum: 30 psi (2.07 bar)

Maximum: 100 psi (6.89 bar)

Materials of Construction:

Body: 316 SS

Finish: Plain

Flow / Pressure Chart

Inlet Pressure psi (bar)	Foam Solution gpm (lpm)
100 (6.89)	31 (117)
80 (5.52)	28.7 (109)
70 (4.83)	26 (98)
50 (3.45)	22 (83)
30 (2.07)	16.5 (62)

Spray Pattern Range Data

Inlet Pressure psi (bar)	"L" - Length ft (m)	"W" - Width ft (m)
100 (6.89)	20 (6.1)	15 (4.57)
50 (3.45)	15 (4.57)	12 (3.66)
30 (2.07)	12 (3.66)	9 (2.74)

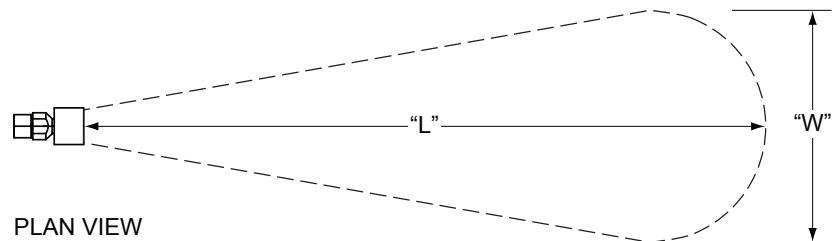

PLAN VIEW

Note: Spray pattern based on nozzle mounted 36" (914.4 mm) above grade.

ORDERING INFORMATION

Part Number	Description
1255-2834-3	KF40 Nozzle, Directional 3/4 (F)NPT