

# KF40 DIRECTIONAL ASPIRATED FOAM WATER NOZZLE

NDD410

- Capable Of Being Mounted In Any Position Or Direction
- Lightweight High-Grade Stainless Steel Construction
- BSP Or NPT Inlet
- Pinpoint Foam Application
- Loading Racks, Process Pumps, Process Piping
- Seawater Compatible
- AR-AFFF/AFFF and Protein Compatible



## Description

The KF40 directional foam/water nozzle is constructed of stainless steel, and operates at a 3.1 K-factor. The nozzle shall be installed in fixed installations aimed in any direction. The nozzle is aspirated and suitable for use with AR-AFFF/AFFF and Protein foam solutions.

## Features

- Capable of being mounted in any position
- Lightweight, investment cast welded, high-grade stainless steel construction
- BSP or NPT inlet
- Special order inlets available upon request

## Applications

Ideal for loading racks, containment areas, rail car loading areas, heliports, truck loading racks, and process areas.

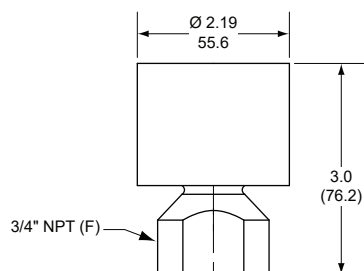

## Technical Data

### Description:

Foam/Water Nozzle

### Manufacturer:

National Foam

### Model:

Directional

### K-factor:

3.1

### Connection:

3/4" FNPT (w/o adapter 3/4" BSP)

### Operating Range:

Minimum: 30 psi (2.07 bar)

Maximum: 100 psi (6.89 bar)

### Materials of Construction:

Body: 316 SS

Finish: Plain

## Flow / Pressure Chart

Inlet Pressure psi (bar)	Foam Solution gpm (lpm)
100 (6.89)	31 (117)
80 (5.52)	28.7 (109)
70 (4.83)	26 (98)
50 (3.45)	22 (83)
30 (2.07)	16.5 (62)

## Spray Pattern Range Data

Inlet Pressure psi (bar)	"L" - Length ft (m)	"W" - Width ft (m)
100 (6.89)	20 (6.1)	15 (4.57)
50 (3.45)	15 (4.57)	12 (3.66)
30 (2.07)	12 (3.66)	9 (2.74)

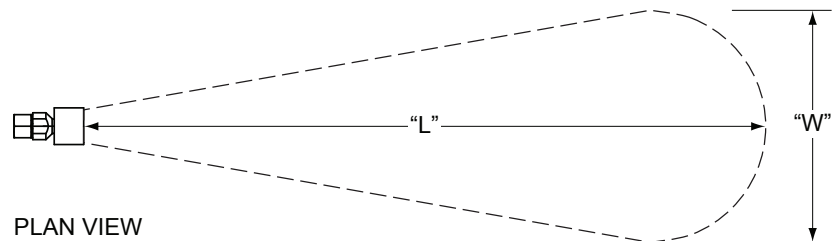

PLAN VIEW

**Note:** Spray pattern based on nozzle mounted 36" (914.4 mm) above grade.

## ORDERING INFORMATION

Part Number	Description
1255-2834-3	KF40 Nozzle, Directional 3/4 (F)NPT