

KF40 PENDENT FOAM WATER NOZZLE

NDD415

- Aspirating Nozzle
- Lightweight, Investment Cast Welded, High-Grade Stainless Steel Construction
- NPT Inlet, BSP Inlet with Adapter Removed
- Special Order Inlets Available Upon Request
- AR-AFFF/AFFF and Protein Compatible



Description

The KF40 pendent foam/water nozzle is constructed of stainless steel, and operates at a 3.1 K-factor. The nozzle shall be installed in fixed installations in the pendent position. The nozzle is aspirated and suitable for use with AR-AFFF/AFFF and Protein foam solutions.

Features

- Lightweight, investment cast welded, high-grade stainless steel construction
- NPT inlet (BSP w/ adapter removed)
- Special order inlets available upon request

Applications

Ideal loading racks, containment areas, and process areas.

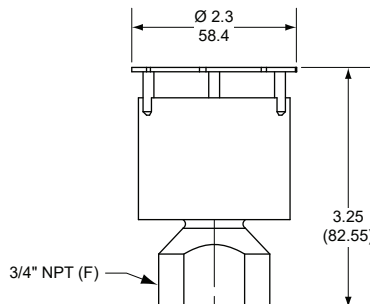

Technical Data

Description:

Foam/Water Nozzle

Manufacturer:

National Foam

Model:

Pendent

K-factor:

3.1

Connection:

3/4" FNPT (w/ 3/4" BSP adapter)

Operating Range:

Minimum: 30 psi (2.07 bar)

Maximum: 100 psi (6.89 bar)

Materials of Construction:

Nozzle:

Body: 316 SS

Finish: Plain

BSP to FNPT Adapter:

Material: Brass

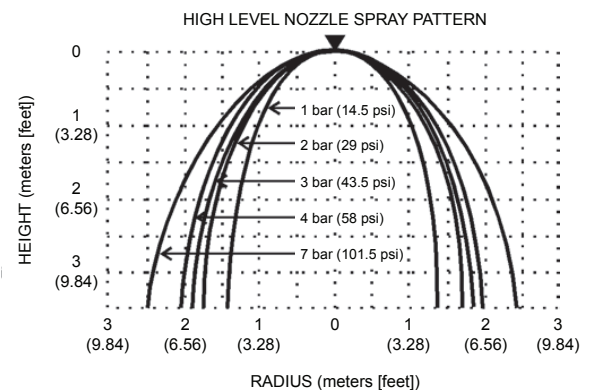

Note: Typical print diameter = 3.9 m (12.8 ft) at 4 barg (58 psig) when mounted 2.5 m (8.2 ft) above ground.

ORDERING INFORMATION

Part Number	Description
1255-2834-4	KF40 Nozzle, Pendent 3/4 (F)NPT